

Baruch **BPAC** **PERFORMING ARTS CENTER**

TEL: 646.312.4082
 FAX: 646.312.4084
 WEB: www.baruch.cuny.edu/bpac

VENUE
 NAGELBERG THEATRE
 55 LEXINGTON AVENUE
 NEW YORK, NY 10010

PROJECT
 N/A

REVISIONS/REISSUES

DATE	DESCRIPTION

SURVEY ALL MEASUREMENTS ON SITE BEFORE CONSTRUCTION

DRAWING NAME

**NAGELBERG THEATRE
 END STAGE
 PLAN & SEC.**

SCALE: 1/8" = 1'-0" PROJ. MGR.: N/A

ORIGIN DATE: 10/21/05 DRAWN BY: A.J.C.

PROJ. NO.: CHECK BY:

PLATE #

1
 OF 1

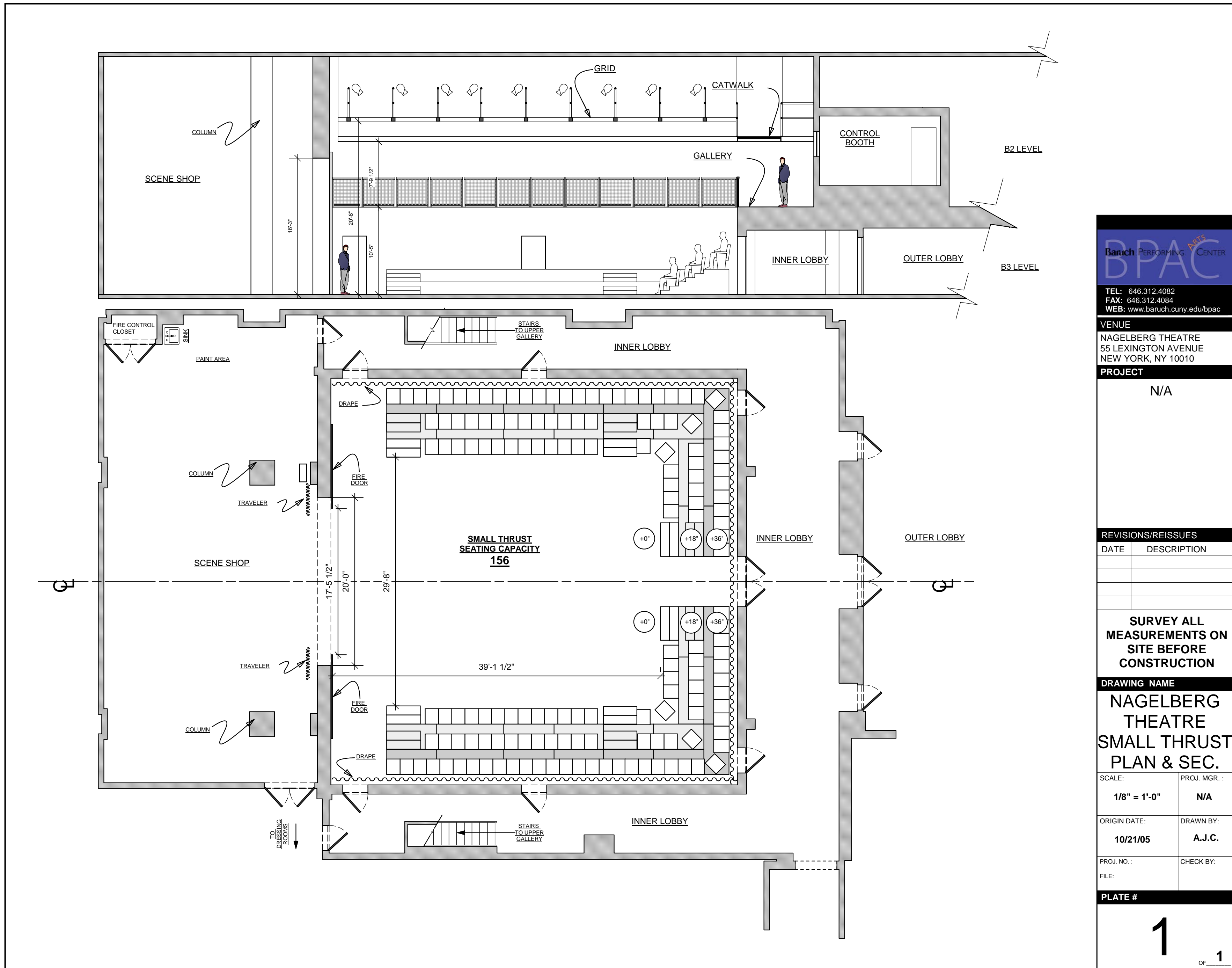

TEL: 646.312.4082
 FAX: 646.312.4084
 WEB: www.baruch.cuny.edu/bpac

VENUE
 NAGELBERG THEATRE
 55 LEXINGTON AVENUE
 NEW YORK, NY 10010

PROJECT
 N/A

REVISIONS/REISSUES

DATE	DESCRIPTION

SURVEY ALL MEASUREMENTS ON SITE BEFORE CONSTRUCTION

DRAWING NAME

**NAGELBERG THEATRE
 SMALL THRUST
 PLAN & SEC.**

SCALE: 1/8" = 1'-0"
 PROJ. MGR.: N/A

ORIGIN DATE: 10/21/05
 DRAWN BY: A.J.C.

PROJ. NO.:
 FILE:
 CHECK BY:

PLATE #

1
 OF 1

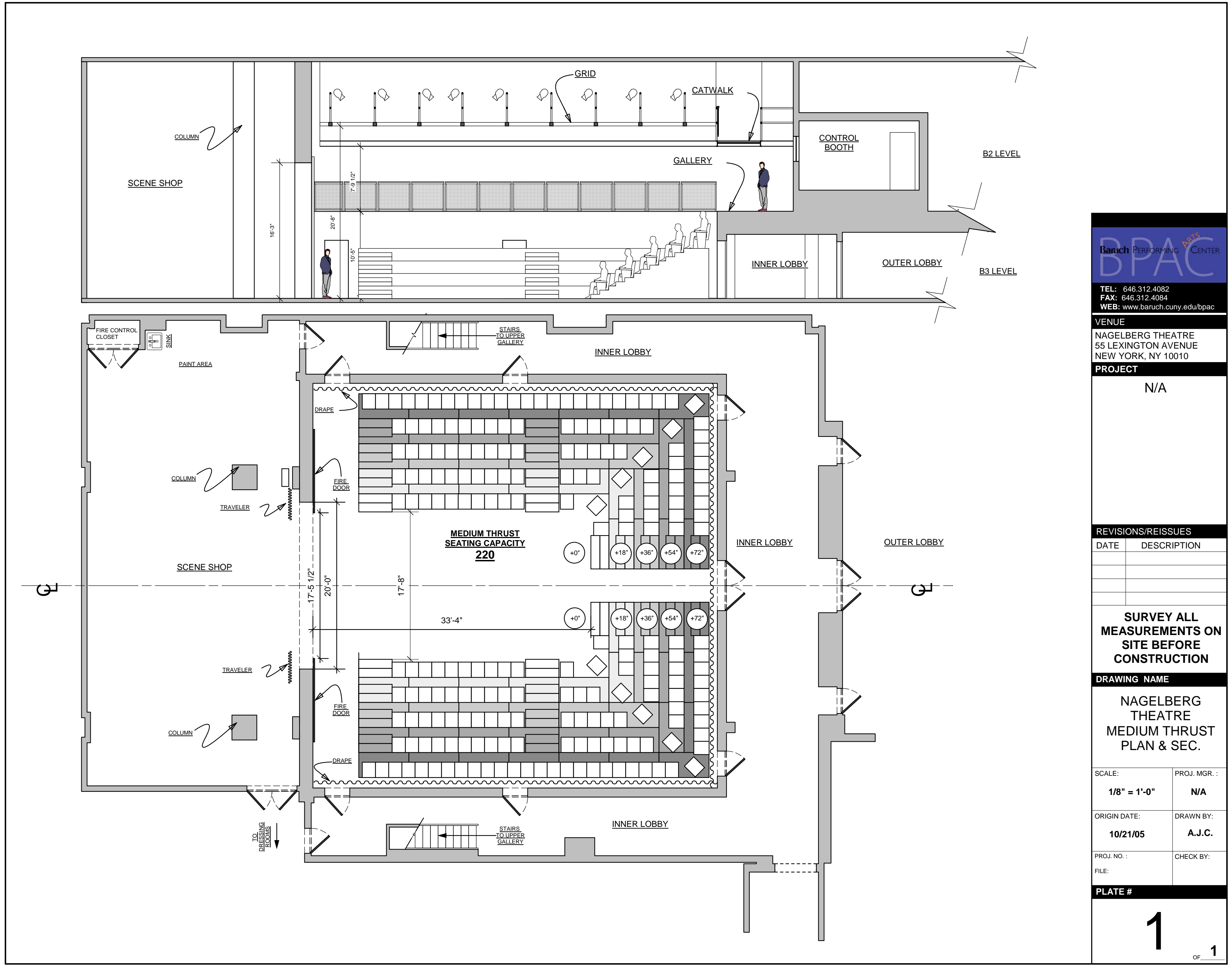

Baruch PERFORMING ARTS CENTER
BPAC

TEL: 646.312.4082
 FAX: 646.312.4084
 WEB: www.baruch.cuny.edu/bpac

VENUE
 NAGELBERG THEATRE
 55 LEXINGTON AVENUE
 NEW YORK, NY 10010

PROJECT
 N/A

REVISIONS/REISSUES	
DATE	DESCRIPTION

SURVEY ALL MEASUREMENTS ON SITE BEFORE CONSTRUCTION

DRAWING NAME
 NAGELBERG THEATRE
 MEDIUM THRUST
 PLAN & SEC.

SCALE: 1/8" = 1'-0"	PROJ. MGR.: N/A
ORIGIN DATE: 10/21/05	DRAWN BY: A.J.C.
PROJ. NO.:	CHECK BY:
FILE:	

PLATE #
1
 OF 1